

## Wireless Transmission Module



### Features:

- 3xAA alkaline batteries works up to 100 hours on 20°C at the lowest power set up
- Water-proof, IP67
- Wireless Frequency: 433MHz or 915MHz
- Transmission Range: Up to 75m without obstruction

### Complete Set Includes:

- One external wireless transmission module WLxx-RFTM-17
- One 7-pin connect included, which can connect the cable with external diameter of 5 - 8mm
- One 805HP-01-WLxx wireless weighing indicator

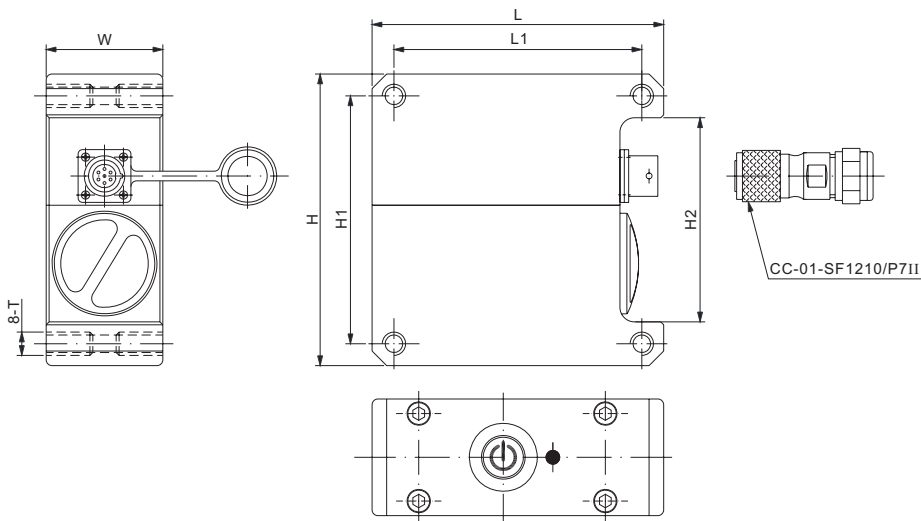

### DIMENSIONS

	H	H1	H2	L	L1	W	T
mm	100.0	85.0	70.0	100.0	85.0	40.0	M8 Depth15
inches	3.94	3.35	2.76	3.94	3.35	1.57	M8 Depth0.59

### SPECIFICATIONS

Connected Type		Any kind of mV/V output load cell, force transducer, sensor or scale
Net Weight	kg/lb	0.7 / 1.5
Transmission Range	m	Up to 75 without obstruction
Operation Time	hours	Up to 100 on 20°C at the lowest power set up
Working Temperature	°C/°F	-20 to 70 / -4 to 158
Wireless Frequency	Mhz	433; 915
Power Supply		3xAA Alkaline batteries (not included)
IP Rating		IP67
Enclosure Material		PVC

### PART NUMBER

Part No.	Frequency	Net Weight (kg)
WL01-RF-17.....	433MHz.....	1.1
WL02-RF-17.....	915MHz.....	1.1

### CONNECTION DIAGRAM

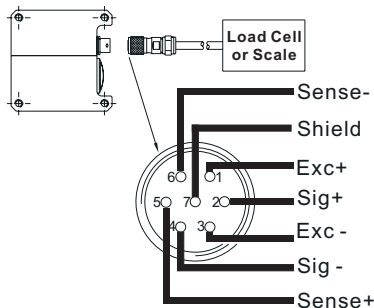



Keyboard Configuration

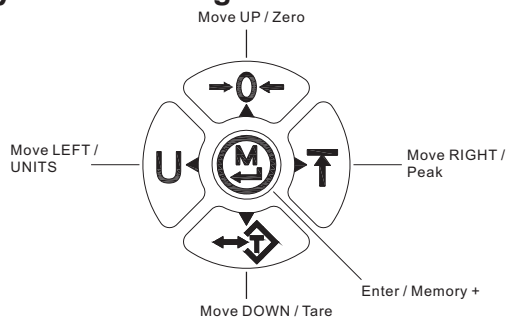

Features:

- 3xAA alkaline batteries works up to 100 hours on 20°C at the lowest power set up
- Material: ABS
- IP Rating: IP65
- LCD 6-digit display with LED backlight
- Non-volatile memory for reliable data saving
- Units of Measurement: kg, g, t, lb,Klb, N, kN, oz, user-defined unit
- Configurable 2 set-points for precaution and warning
- User-selectable display interval
- Overloading recording
- 10 user-selectable analog-to-digital converting frequency
- Weight calibration and digital calibration
- User-selectable auto power-off and power-saving timing
- Functions: Auto-Zero-Tracking, Auto-Zero, Manual-Zero, Hold, Peak-Hold, TARE

General Specifications	
Enclosure Material	ABS
Units of Measurement	kg, g, t, lb,Klb, N, kN, oz, user-defined unit
Working Temperature	-20°C to 70°C / -4°F to 158°F
Dimensions	170mm×98mm×34mm
	6.7in×3.9in×1.34in
Display Type	LCD
Display Digits	6 digits
Digit Height	16.8mm / 0.66in
Display Dimensions	72mm×27mm / 2.8in×1.1in
Power Supply	3×AA Alkaline batteries (not included)
IP Rating	IP65

Technical Specifications	
Division	0.001; 0.002; 0.005; 0.01; 0.02; 0.05; 0.1; 0.2; 0.5; 1; 2; 5; 10; 20; 50
Tare range	100% Full Scale
Max. Power Consumption	6.25mW
Wireless Distance	Up to 75m without obstruction

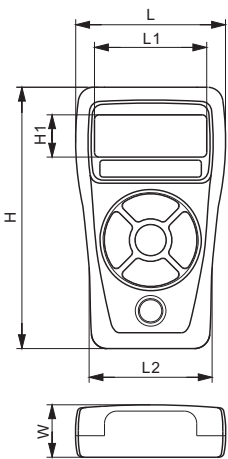

DIMENSIONS						
	H	H1	L	L1	L2	W
inches	6.7	1.1	3.9	2.8	3.2	1.3
mm	170	27	98	72	80	34

## Product Datasheet Disclaimer

### Information Changes:

All product specifications, statements, information, and data (collectively, the "Information") in this catalog or made available elsewhere by ANYLOAD are subject to change. Customers must verify the applicability of the Information at the time of order placement.

### Accuracy and Reliability:

While all Information is believed to be accurate and reliable, it is presented without guarantee, warranty, or responsibility of any kind, expressed or implied.

### Laboratory Conditions:

Data listed in the datasheet is produced within controlled laboratory settings and may not be reproducible without exact replication of all metrological conditions. Users must validate that a product with the described properties is suitable for their applications.

### Interchangeability:

Statements of interchangeability with other manufacturers are based on ANYLOAD's knowledge at the time of publication and are not intended to constitute any warranty concerning the substitutability of an ANYLOAD product with one made by another Manufacturer.

### Warranty Voidance:

Any use of the product outside of specifications or any storage or installation inconsistent with product guidance voids any warranty.

### Intended Use:

The information is intended for use only by customers who have the requisite experience and capability to determine the correct products for their application. ANYLOAD provides technical advice without obligation or liability for the advice given or results obtained.

### Component Failures:

Although ANYLOAD designs and manufactures its products to stringent quality and safety standards, isolated component failures may still occur. Applications requiring high reliability or safety should employ suitable designs or safeguards to ensure that component failure does not result in personal injury or property damage.

### High-Risk Applications:

Unless specifically agreed to in writing, ANYLOAD has not tested or certified its products, services, or deliverables for use in high-risk applications (e.g., medical life support, nuclear facilities, weapon systems). ANYLOAD makes no assurances that the products are suitable for high-risk uses. Under no circumstances does ANYLOAD warrant or guarantee suitability for any customer design or manufacturing process.

Contact authorized ANYLOAD personnel for special terms and conditions regarding products designed for specific safety requirements.

### Safety Measures:

All product-related warnings, cautions, and notes must be observed. Customers should not assume that all safety measures are indicated or that other measures may not be required.

---

### California Proposition 65:

 **WARNING:** Some products manufactured or distributed by ANYLOAD may contain trace amounts of chemicals known to the State of California to cause cancer, birth defects, or other reproductive harm. These substances are present in minimal quantities and are typically encapsulated within our products. This warning is provided to enable you to make informed decisions as a consumer.